

# SPACERS

# STANDOFFS THRUHOLE, ROUND

## SPACER, THREADED, HEX

Stainless Steel per ASTM A314/A581/A582

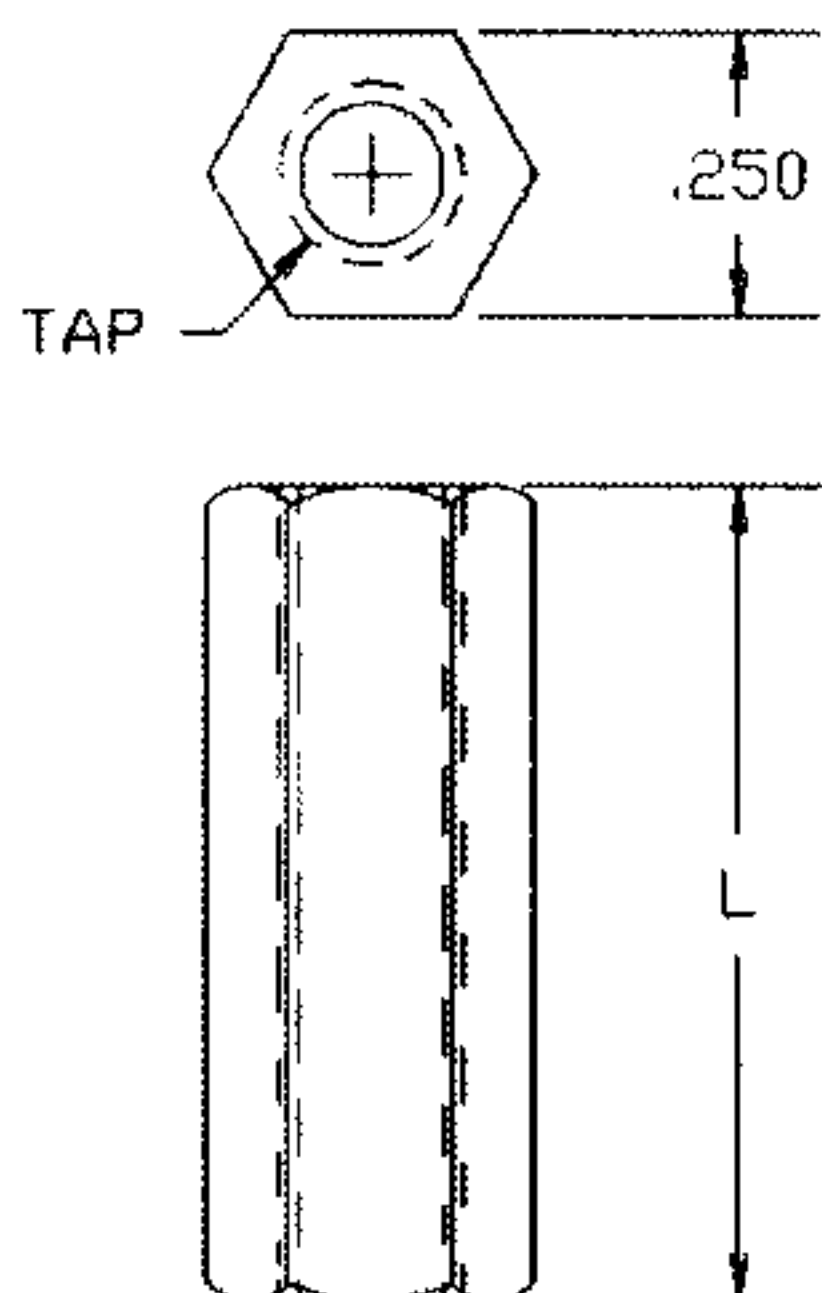

L	4-40 THREAD	6-32 THREAD	8-32 THREAD
.250	435S-9404	435S-9604	435S-9804
.312	435S-9405	435S-9605	435S-9805
.375	435S-9406	435S-9606	435S-9806
.437	435S-9407	435S-9607	435S-9807
.500	435S-9408	435S-9608	435S-9808
.625	435S-9410	435S-9610	435S-9810
.750	435S-9412	435S-9612	435S-9812
.875	435S-9414	435S-9614	435S-9814
1.000	435S-9416	435S-9616	435S-9816
1.250	435S-9420	435S-9620	435S-9820
1.500	435S-9424	435S-9624	435S-9824
2.000	435S-9432	435S-9632	435S-9832

4-40 THREAD ON 1/2" AND OVER TAPPED 1/4" EACH END. 6-32 & 8-32 THREAD ON 1" AND OVER TAPPED 3/8" EACH END

## GLAZED CERAMIC GRADE L-5, MEETS MIL-I-10

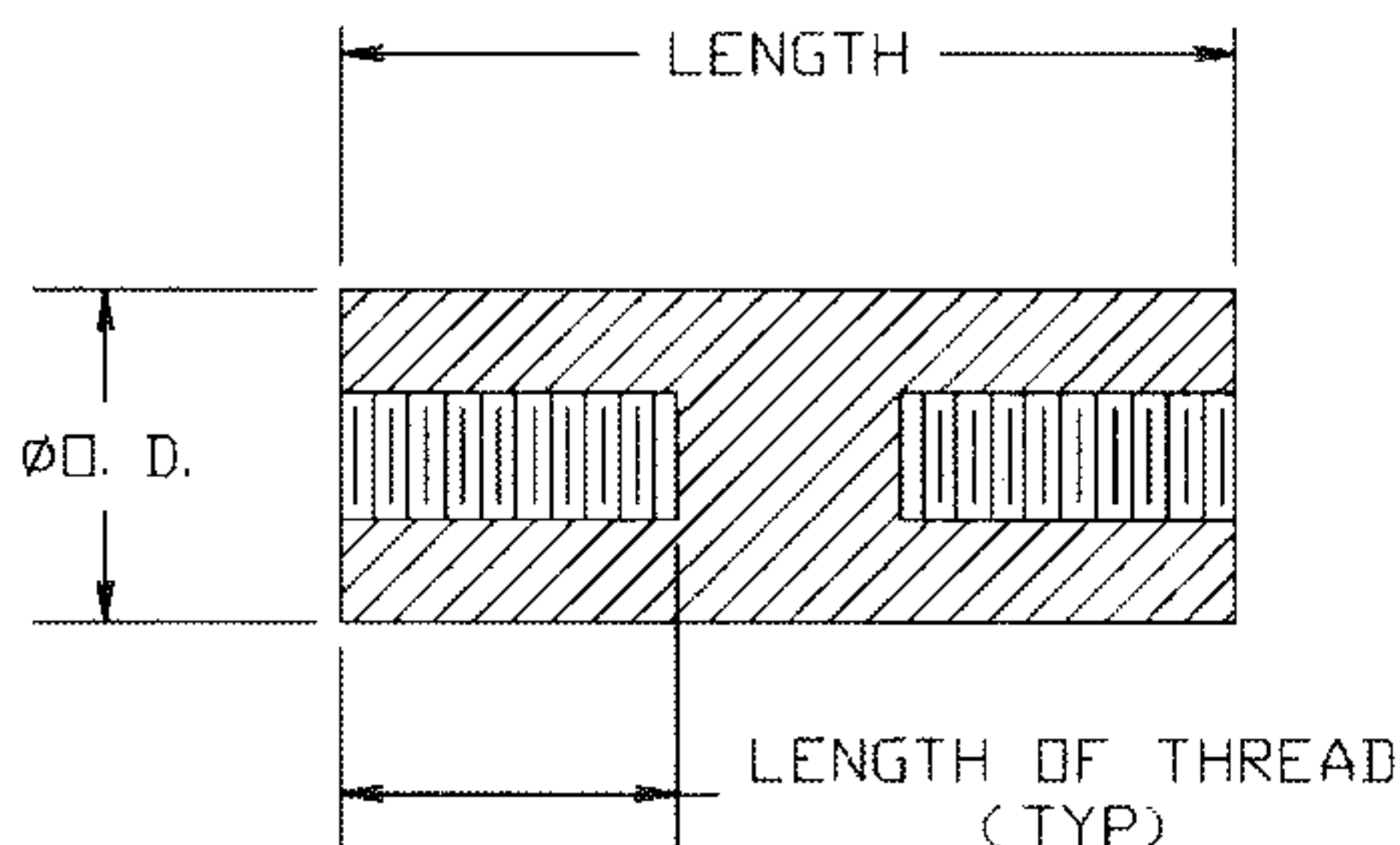

Concord No.	Length	Depth of Thread	MIL. Number
<b>6-32 THREAD 3/8" O.D.</b>			
500-1005	1/2	5/32	NL-523-W01-004
500-1010	5/8	1/4	NL-523-W01-005
500-1011	3/4	1/4	NL-523-W01-006
500-1012	1	3/8	NL-523-W01-008
500-1013	1-1/4	3/8	NL-523-W01-010
500-1014	1-1/2	3/8	NL-523-W01-012
500-1015	2	3/8	NL-523-W01-016
<b>8-32 THREAD 1/2" O.D.</b>			
500-1020	5/8	3/16	NL-523-W02-005
500-1021	3/4	1/4	NL-523-W02-006
500-1022	1	3/8	NL-523-W02-008
500-1023	1-1/4	3/8	NL-523-W02-010
500-1024	1-1/2	3/8	NL-523-W02-012
500-1025	2	3/8	NL-523-W02-016
500-1026	2-1/2	3/8	NL-523-W02-020
500-1027	3	3/8	NL-523-W02-024
<b>10-32 THREAD 3/4" O.D.</b>			
500-1030	1	3/8	NL-523-W03-008
500-1031	1-1/4	3/8	NL-523-W03-010
500-1032	1-1/2	3/8	NL-523-W03-012
500-1033	2	3/8	NL-523-W03-016
500-1034	2-1/2	3/8	NL-523-W03-020
500-1035	3	3/8	NL-523-W03-024
500-1036	4	3/8	NL-523-W03-032
<b>1/4-20 THREAD 1" O.D.</b>			
500-1040	1-1/4	7/16	NL-523-W04-010
500-1041	1-1/2	1/2	NL-523-W04-012
500-1042	2	5/8	NL-523-W04-016
500-1043	2-1/2	5/8	NL-523-W04-020
500-1044	3	5/8	NL-523-W04-024
500-1045	4	5/8	NL-523-W04-032
500-1046	5	5/8	NL-523-W04-040
500-1047	6	5/8	NL-523-W04-048

TOLERANCE: 2% OF DIMENSION PLUS .012

## COMMERCIAL CERAMIC STANDOFFS GRADE L5 GLAZED OUTSIDE

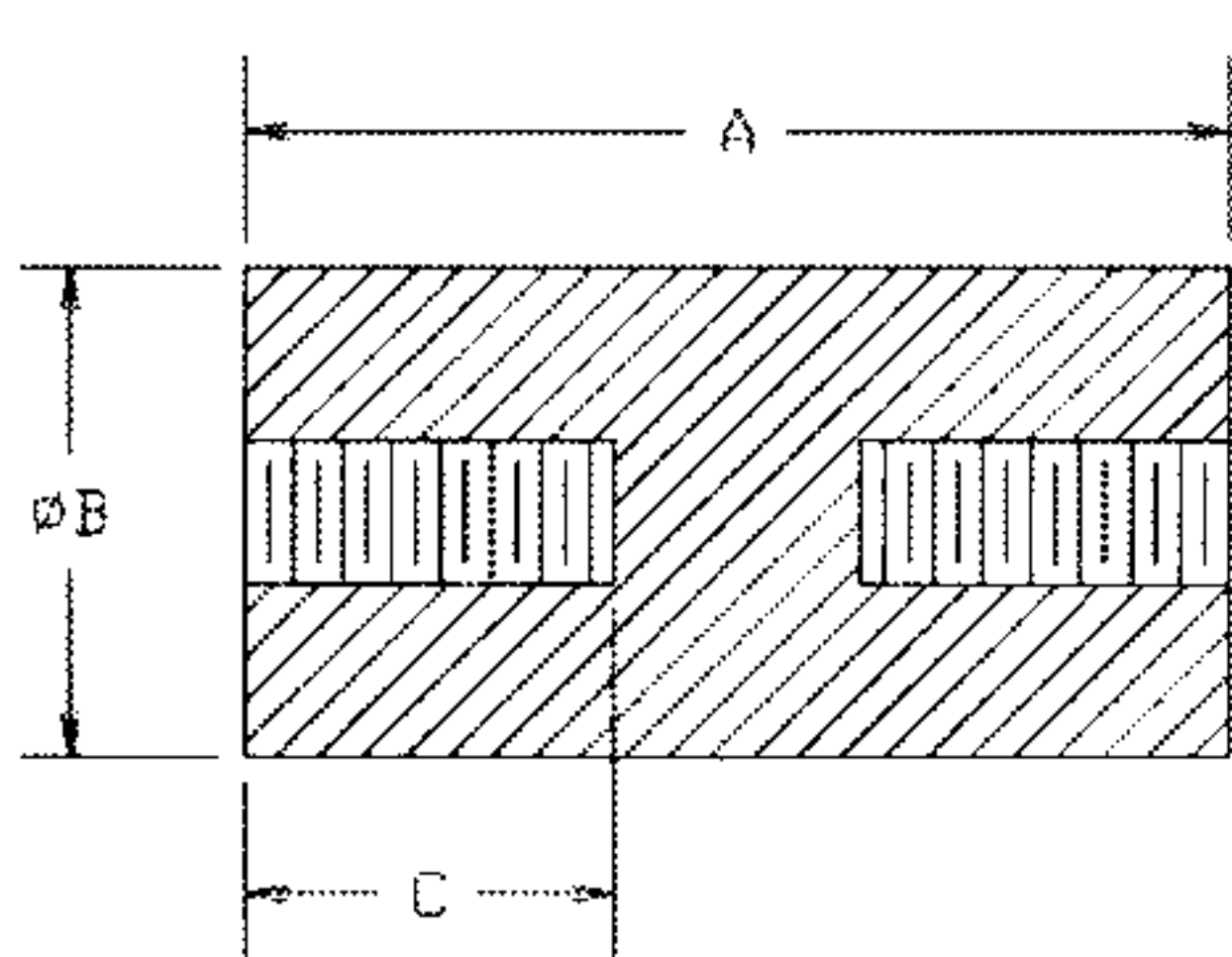

PART NO.	A	B	THD	C
500-1050	1/4	1/4	6-32	Thru
500-1051	1/2	1/4	6-32	5/32
500-1052	3/8	3/8	6-32	5/32
500-1053	1/2	3/8	6-32	3/16
500-1054	1/2	1/2	6-32	9/64
500-1055	3/4	1/2	6-32	1/4
500-1056	1	1/2	6-32	3/8
500-1057	1-1/2	1/2	6-32	9/16
500-1058	2-1/2	1/2	6-32	1/2
500-1059	2-1/2	3/4	1/4-20	3/4
500-1060	4	3/4	1/4-20	3/4

TOLERANCE: 2% OF DIMENSION PLUS .012

## STANDOFFS, THRU HOLE, ROUND

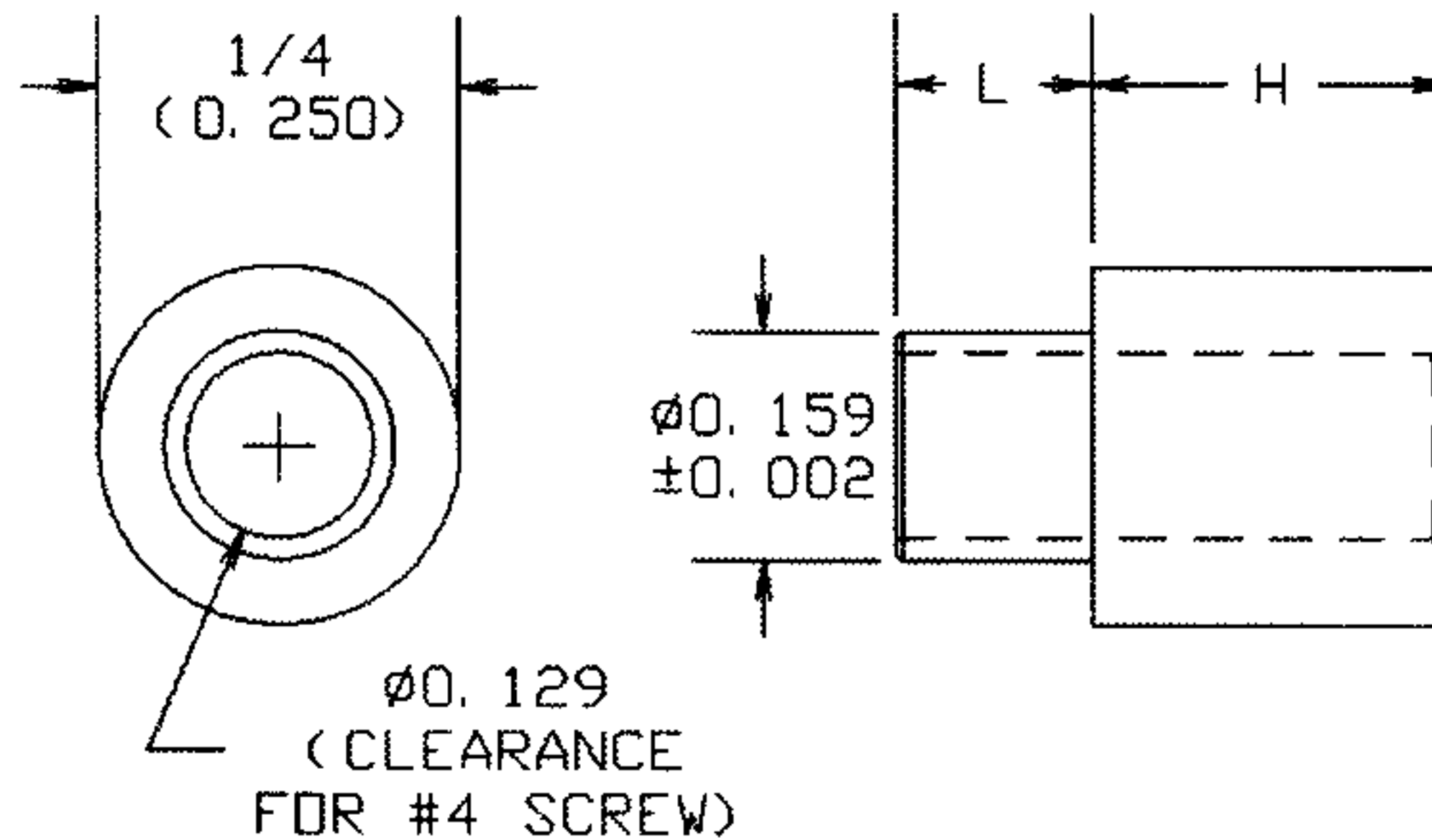

## 5XX-9XXX-02

## 6XXA-9XXX-XX

## BRASS PER ASTM B16

## ALUMINUM PER ASTM B211

BASIC PART NO. FINISH

BOARD THICKNESS	H	L	BRASS	ALUMINUM
1/32	.125	.075	598-9408	698A-9408
1/32	.188	.075	598-9422	698A-9422
1/32	.250	.075	598-9429	698A-9429
1/32	.375	.075	598-9443	698A-9443
1/32	.500	.075	598-9457	698A-9457
1/32	.625	.075	598-9471	698A-9471
1/32	.750	.075	598-9485	698A-9485
1/32	1.000	.075	598-9513	698A-9513
1/16	.125	.105	598-9409	698A-9409
1/16	.188	.105	598-9423	698A-9423
1/16	.250	.105	598-9430	698A-9430
1/16	.375	.105	598-9444	698A-9444
1/16	.500	.105	598-9458	698A-9458
1/16	.625	.105	598-9472	698A-9472
1/16	.750	.105	598-9486	698A-9486
1/16	1.000	.105	598-9514	698A-9514
3/32	.125	.135	598-9410	698A-9410
3/32	.188	.135	598-9424	698A-9424
3/32	.250	.135	598-9431	698A-9431
3/32	.375	.135	598-9445	698A-9445
3/32	.500	.135	598-9459	698A-9459
3/32	.625	.135	598-9473	698A-9473
3/32	.750	.135	598-9487	698A-9487
3/32	1.000	.135	598-9515	698A-9515
1/8	.125	.165	598-9411	698A-9411
1/8	.188	.165	598-9425	698A-9425
1/8	.250	.165	598-9432	698A-9432
1/8	.375	.165	598-9446	698A-9446
1/8	.500	.165	598-9460	698A-9460
1/8	.625	.165	598-9474	698A-9474
1/8	.750	.165	598-9488	698A-9488
1/8	1.000	.165	598-9516	698A-9516

- FOR BRASS PARTS, ADD -02 SUFFIX TO PART NUMBER FOR STANDARD NICKEL FINISH
- FOR ALUMINUM PARTS, ADD -17 SUFFIX TO PART NUMBER FOR STANDARD NON-CHROMATE CLEAR PROTECTIVE COATING OR -16 FOR YELLOW IRRIDITE FINISH.

## SWAGING TOOLS

H	ANVIL	PUNCH
.125	TA250-125	TP160-125
.188	TA250-125	TP160-125
.250	TA250-250	TP160-125
.375	TA250-250	TP160-125
.500	TA250-500	TP160-125
.625	TA250-500	TP160-125
.750	TA250-750	TP160-125
1.000	TA250-750	TP160-125

FOR ADDITIONAL SIZES AND MATERIALS, CONTACT FACTORY

800-847-4162 (Outside N.Y.S.)  
Ph: 212-777-6571 Fax: 212-991-0161  
sales@concord-electronics.com  
engineering@concord-electronics.com

